

LOCATION LIGHT

LM400-VCe / LM800-VCD

0~100% Dimming Control / Durable Metal Body / Compatible with AB & V-Mount /
DMX Ready / Variable Color Temperature / Digital Display /
Flicker-Free / Silent Cooling System / External Power Input



Before Using LED Light

Thank you for purchasing the Cineroid LED light.

The Cineroid LED employs a very high color rendering index (CRI). It displays a very stable color temperature and brightness so that both motion pictures and still images can be taken in their most natural color tones. Please read this user manual thoroughly before using the Cineroid LED.

Test Before Operating

It is recommended to test the Cineroid LED before use. Make sure the light comes on when powered and that the brightness control works properly.

Safety Precautions

Please observe the following safety precautions as they are meant for the safe and proper use of the product to reduce the risk of accidents. Upon reading the user manual, keep it in a safe and available place.

- Do not use any batteries, power cord, or accessories that are not specified in this document.
- When using a power cord, be sure to plug it in completely. Do not handle power plugs when your hands are wet. When unplugging the power cord, grasp the plug body or adapter instead of the cord.
- Power cords that are scratched, heavily bent or twisted can potentially be hazardous and a source of electric shock and/or fire.
- Do not insert foreign objects into the product's electric or cable components.
- Do not place the power cord near sources of heat as this may melt or cause damage to the cord potentially causing fire or electric shock.
- Do not disassemble or modify the product. This may damage the product and cause danger due to a malfunction. Please keep the product out of reach of young children. Injuries may occur due to damage to the product.
- When using the product in an airplane or hospital setting, it is recommended to acquire authorization first as signals or electro-magnetic waves from the product may cause other equipment to malfunction.
- Do not store the product in a dusty or humid environment as damage may occur.
- When the product is mounted on a camera, do not lift or move the camera by grabbing the product. This may cause damage to the product or the camera mount.
- Do not clean the product with paint thinner, benzene, or other volatile solvents. This may cause damage to the product and become a fire hazard.
- This product is not waterproof. If the product is dropped in water, contact the service center immediately.

Parts

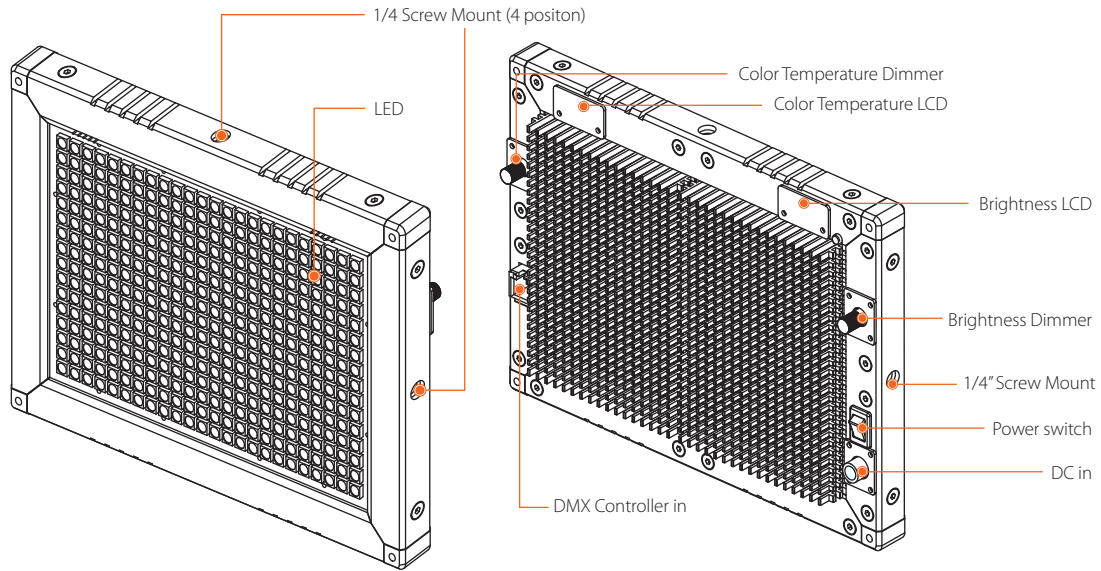

Specification

LM400-VCe	
Size	192 x 142 x 26 mm
Power input	11 ~17 V
Light angle	120 degree
Dimming Control	0~100 %
Mount	1/4" screw mount (4 positions)
Weight	562 g (without Battery)
Display info	Brightness, Color temp., Error
Photometric	1800 Lux / 1 m
Color Temp	2700°K~6500°K \pm 200°K
Power drain	60 W

LM800-VCD	
Size	242 x 192 x 26 mm
Power input	11 ~17 V
Light angle	120 degree
Dimming Control	0~100 %
Mount	1/4" screw mount (4 positions)
Weight	990 g (without Battery)
Display info	Brightness, Color temp., Error
Photometric	3400 Lux / 1 m
Color Temp	2700°K~6500°K \pm 200°K
Power drain	120 W

Connecting External Power

1. In addition to the rechargeable battery, external power sources can also be used to power the light.
2. 12V / 6A external power is recommended for LM400.
12V / 12A external power is recommended for LM800.
3. Remove the battery mount plug from the body.
4. Insert the power plug from the external power source.

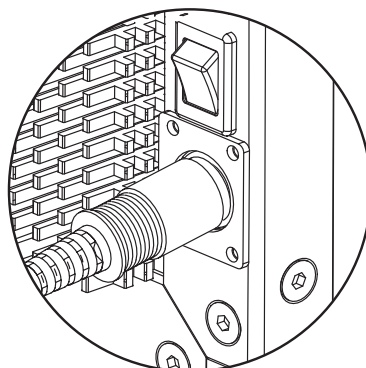
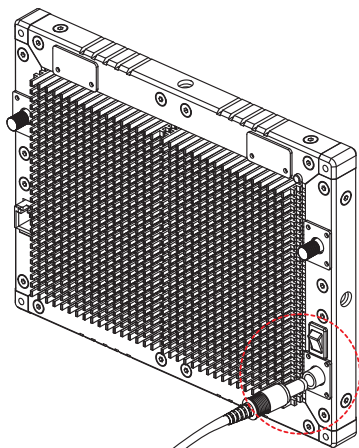

DC in 11~17V

Installing the Battery Mount (Optional)

1. Attach the battery mount (optional product) to the back of the body by using the 4 screws on the mount.
2. Attach the battery to the battery mount. Be sure to charge fully the battery before installing.

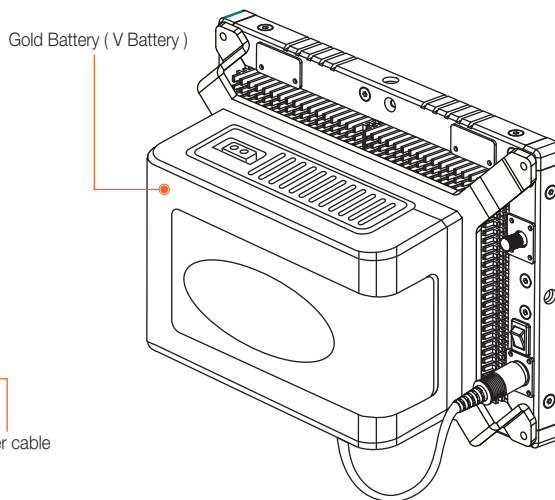
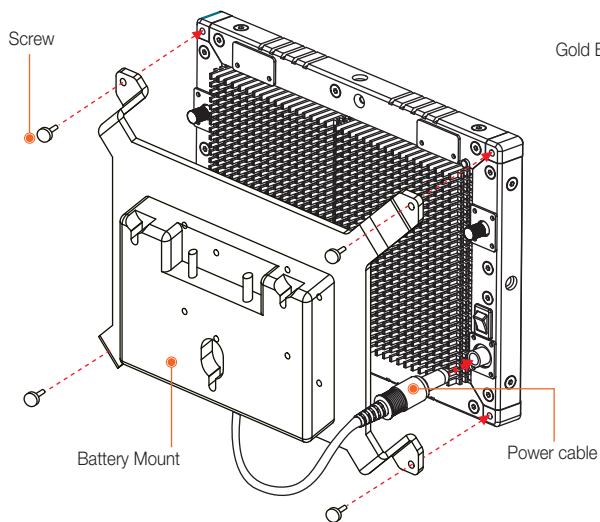

Setting / Control

1. Power On / Off

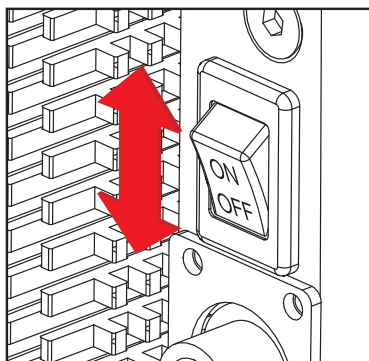

Push the power switch to "ON" to turn on the LED light. Check if the information is displayed properly. Push the power switch to "OFF" to turn off the LED light.

2. Control Brightness

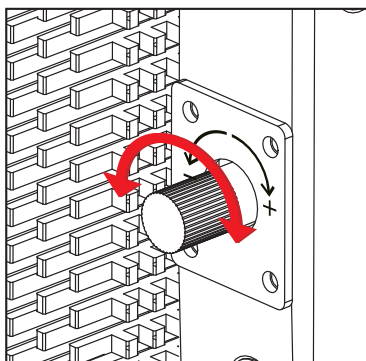

Turn the brightness dial side to side to adjust the brightness. The brightness range is from 0~100% and the current level is displayed on LCD. Turning the dial to the right increases brightness. Turning the dial to the left decreases brightness. When brightness value is zero, LED lights become off.

3. Control Color Temperature

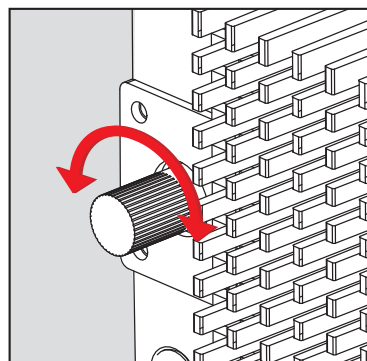

Turn the Color Temperature dial side to side to adjust the Color Temperature. The color temperature range is from 2700° K ~ 6500° K and the current level is displayed on Color temperature LCD.

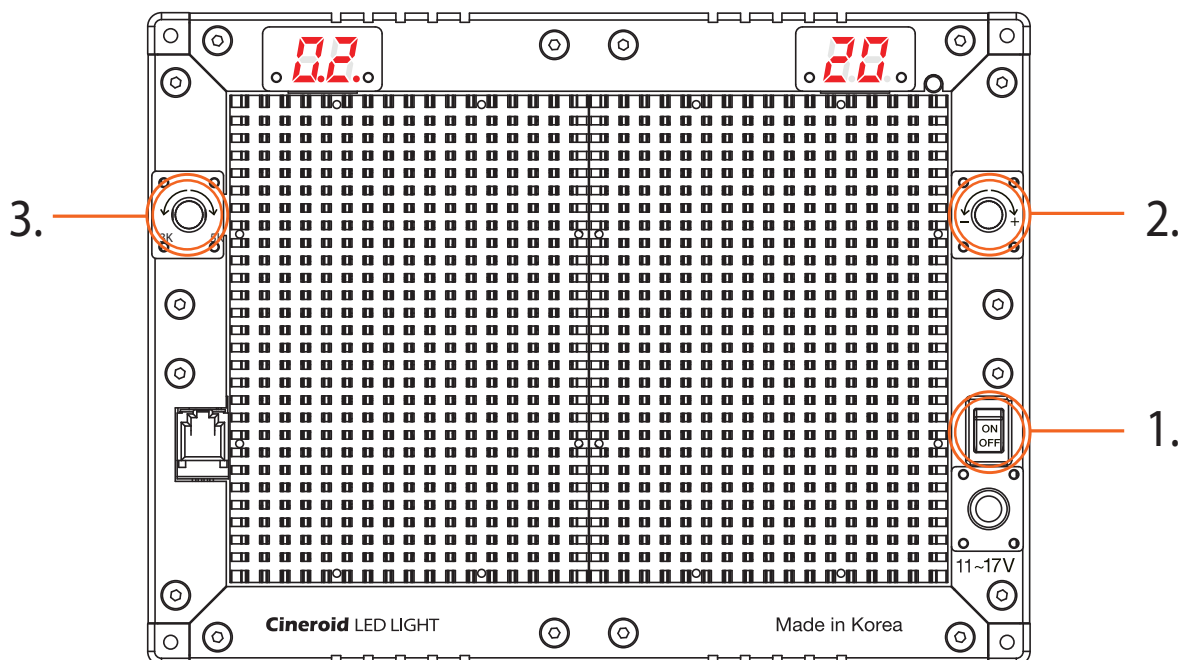

Optional Products

						
PA05 DC Plug with D-tap	BD04 LM400 Barn Door	DMX400 LM400 DMX Encoder	BH-LM400V LM400 V Battery Mount	BH-LM400G LM400 Gold Battery Mount	QBG004 LM400 Bag	QBG008 LM400 x 4 Bag
						
LY-4x1 LM400 Yoke	LD-4M LM400 Snap-in diffuser	LD-4MS LM400 Snap-in Diffuser with Rails	LD-8M LM800 Snap-in diffuser (Rail type)	BD08M LM800 Barn Door	BH-LM800V LM800 V Battery Mount	RC-400 LM400 / LM800 Rain Cover

Package Contents

LM400-VCe

- LM400-VCe Body
- AC Adapter
- Manual

LM400-VCeS

- LM400-VCe Body
- AC Adapter
- Barn Door
- Yoke
- Diffuser
- Manual
- Bag

LM400-3 SETV

- LM400-VCe body 3 units
- Yoke for each body
- Barn door for each body
- Diffuser for each body
- AC adapter for each body
- V battery mount for each body
- Full size soft carrying bag
- Manual

LM400-VCe

LM800-VCDV

- LM800-VCD body
- V Battery Mount
- Manual
- AC Adapter
- Yoke
- Barn door
- Diffuser panel

LM800-VCDG

- LM800-VCD body
- Gold Battery Mount
- Manual
- AC Adapter
- Yoke
- Barn door
- Diffuser panel

LM800-VCD

Cineroid®

Cinema & Broadcasting Equipment

sales@secu-line.com

Tel:+82.70.4347.4901

Fax:+82.70.4347.4999

Room.510, 55 (Kolon Science Vally #2), Digital-ro 34-gil, Guro-gu, Seoul, KOREA 08378

www.cineroid.com

Manufactured by SECULINE

SECULINE Co.,Ltd.

Made in Korea

